



## KUEBLER - INCREMENTAL ENCODER 3610/3620 SERIE 3610



- Housing diameter Ø36 mm
- M12 connector
- 25 to 2 500 pulses per revolution



### PRODUCT DESCRIPTION

Model Series 3610/3620 is small and robust with up to 2 500 pulses per revolution.

Available in Shoulder and Hole Axle Design, with Push-Pull or RS422.

Suitable for applications where space is limited.

Different options with radial, axial cable or M12 (8 pin).

Please refer to the images below for ordering information.

Order code		8.3610 . XXXXX . XXXX				
Shaft version		Type	a	b	c	d
<b>a</b> Flange						
2 = synchro flange, ø 36.5 mm [1.44"]						
3 = clamping flange, ø 36.5 mm [1.44"]						
<b>b</b> Shaft (ø x L)						
1 = ø 4 x 10 mm [0.16 x 0.39"]						
2 = ø 5 x 10 mm [0.20 x 0.39"]						
3 = ø 6 x 12.5 mm [0.24 x 0.49"], with flat						
5 = ø 1/4" x 12.5 mm [1/4" x 0.49"], with flat						
<b>c</b> Output circuit / power supply						
2 = push-pull (with inverted signal) / 5 ... 18 V DC						
4 = push-pull (with inverted signal) / 8 ... 30 V DC						
3 = push-pull (without inverted signal) / 8 ... 30 V DC						
6 = RS422 (with inverted signal) / 5 V DC						
5 = RS422 (with inverted signal) / 8 ... 30 V DC						
<b>d</b> Type of connection						
1 = axial cable, 2 m [5.56'] PVC						
A = axial cable, special length PVC *)						
2 = radial cable, 2 m [5.56'] PVC						
B = radial cable, special length PVC *)						
3 = axial M12 connector, 8-pin						
4 = radial M12 connector, 8-pin						
*) Available special lengths (connection types A, B):						
3, 5, 8, 10, 15 m [9.84, 16.40, 26.25, 32.80, 49.21']						
order code expansion .XXXX = length in dm						
ex.: 8.3610.334A.1024.0030 (for cable length 3 m)						
<b>e</b> Pulse rate						
25, 100, 200, 360, 500, 512, 600, 1000,						
1024, 1500, 2000, 2048, 2500						
(e.g. 500 pulses => 0500)						
Optional on request						
- other pulse rates						

## Order code Hollow shaft

**8.3620**

Type

**. XXXXX**

Type

**. XXXXX**

Type

**. XXXXX**

Type

**. XXXXX**

Type

**. XXXXX**

Type

**. XXXXX**

Type

**. XXXXX**

Type

**. XXXXX**

Type

**. XXXXX**

Type

**. XXXXX**

Type

**. XXXXX**

Type

**. XXXXX**

Type

**. XXXXX**

Type

**. XXXXX**

Type

**. XXXXX**

Type

**. XXXXX**

Type

**. XXXXX**

Type

**. XXXXX**

Type

**. XXXXX**

Type

**. XXXXX**

Type

**. XXXXX**

Type

**. XXXXX**

Type

**. XXXXX**

Type

**. XXXXX**

Type

**. XXXXX**

Type

**. XXXXX**

Type

**. XXXXX**

Type

**. XXXXX**

Type

**. XXXXX**

Type

**. XXXXX**

Type

**. XXXXX**

Type

**. XXXXX**

Type

**. XXXXX**

Type

**. XXXXX**

Type

**. XXXXX**

Type

**. XXXXX**

Type

### a Flange

- 1 = with spring element, short
- 2 = with spring element, long**
- 5 = with stator coupling,  $\varnothing$  46 mm [1.81"]

### b Through hollow shaft

- 2 =  $\varnothing$  6 mm [0.24"]**
- 4 =  $\varnothing$  8 mm [0.32"]
- 3 =  $\varnothing$  1/4"

### c Output circuit / power supply

- 2 = push-pull (with inverted signal) / 5 ... 18 V DC
- 4 = push-pull (with inverted signal) / 8 ... 30 V DC**
- 3 = push-pull (without inverted signal) / 8 ... 30 V DC
- 6 = RS422 (with inverted signal) / 5 V DC
- 5 = RS422 (with inverted signal) / 8 ... 30 V DC

### d Type of connection

- E = radial cable, 2 m [5.56'] PVC**
- B = radial cable, special length PVC \*)
- 4 = radial M12 connector, 8-pin
- \*) Available special lengths (connection type B):  
3, 5, 8, 10, 15 m [9.84, 16.40, 26.25, 32.80, 49.21']  
order code expansion .XXXX = length in dm  
ex.: 8.3620.224B.1024.0030 (for cable length 3 m)

### e Pulse rate

- 25, 100, **200**, 360, **500**, 512, 600, 1000,  
**1024**, 1500, 2000, **2048**, **2500**  
(e.g. 500 pulses => 0500)

Optional on request  
- other pulse rates

## TECHNICAL DATA

Connection	Cable, M12
Frequency	200kHz
Housing diameter	36 mm
IP class	IP65
Material cable	PVC
Material of sensor housing	Aluminium
Mounting	Shoulder
Output	Push/Pull, RS422
Pulse max	2500
Rotation speed	12000 rpm
Sensor type	Incremental
Shaft diameter max	6 mm
Shaft diameter min	4 mm
Supply voltage dc max	30 V DC
Supply voltage dc min	5 V DC
Temperature operational max	85 °C
Temperature operational min	-20 °C
Weight	80 g

### 2 - Syncrofläns

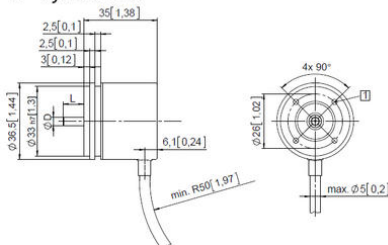

### 3 - klämfläns

